

KEY



PROPOSED NO WAITING 09.30 - 11.30 AND 12.15 - 2.30 MONDAY-FRIDAY



EXISTING NO WAITING RESTRICTIONS

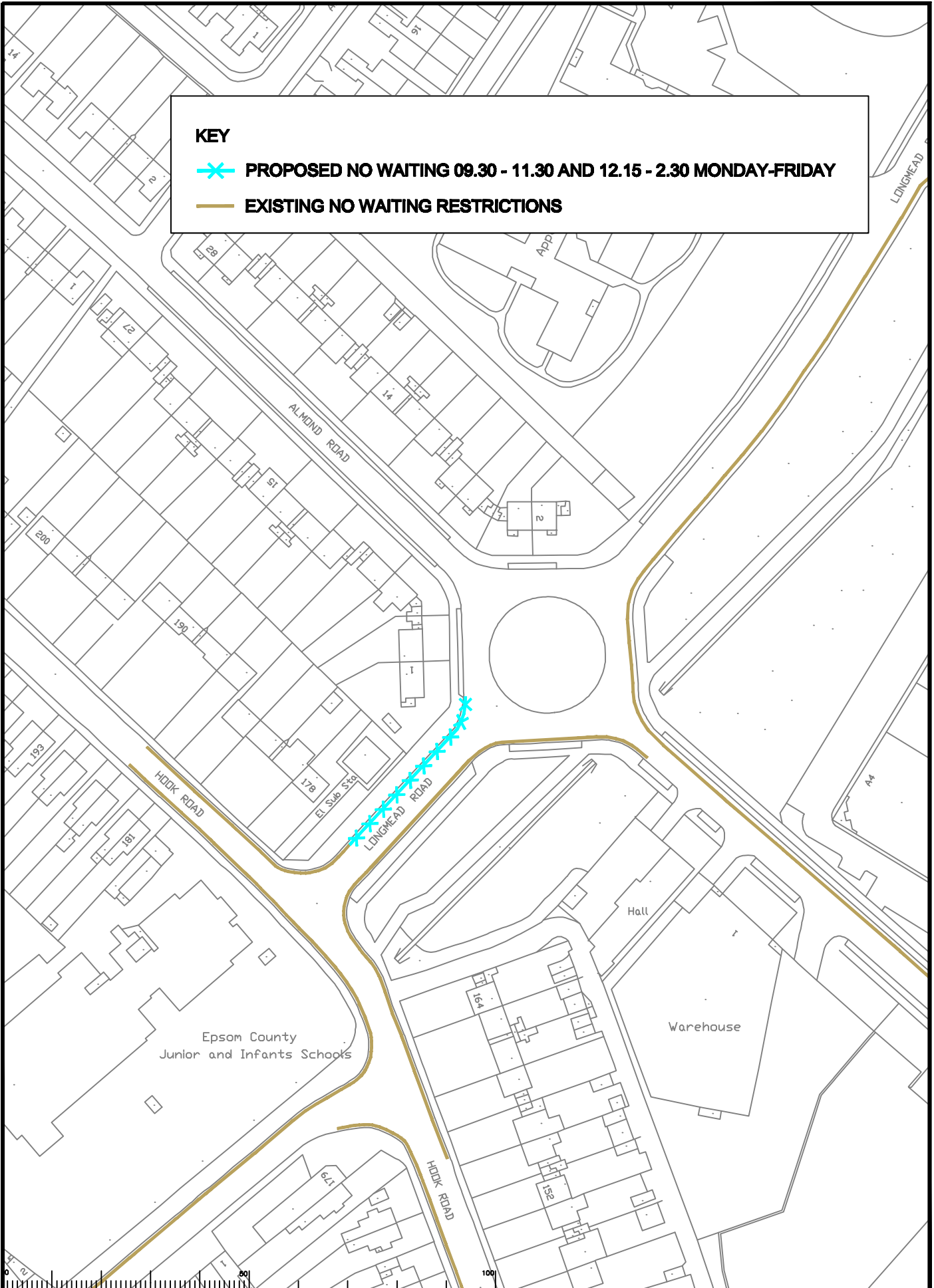

Rev.	Description	Drawn	Slip	Date	Chkd	Slip	Date	Appr	Slip	Date

North Point

Issued upon the Christmas Survey complying with the permission of the Controller of Her Majesty's Revenue and Customs. © Crown copyright. Unauthorised reproduction infringes Crown copyright and may lead to prosecution or other proceedings. Surrey County Council LA 020724 1205

Drawn by	CAH	Slip	CAH	Date	OCT 09
Checked by	SDC	Slip	SDC	Date	OCT 09
Approved by	TPC	Slip	TPC	Date	OCT 09

Project
**EPSOM AND EWELL
 PHASE 4 REVIEW**
 LONGMEAD ROAD

SHEET OF

**SURREY
 COUNTY COUNCIL**
 Local Council
 Council House
 Guildford, Surrey GU1 2AA

Project No.	
Contract Sheet No.	
Drawing No.	34
Rev.	-
Classification	ADVERT